

OPERATION INSTRUCTIONS

Model G8696

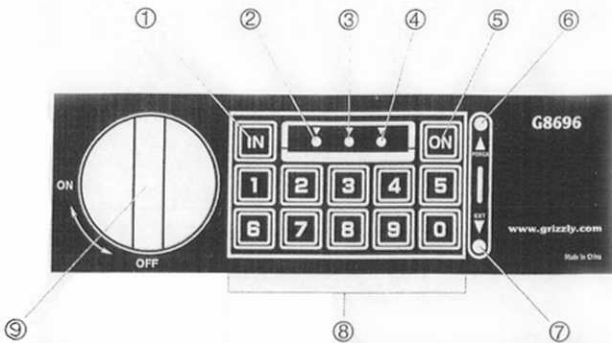

- ① PIN setter or cancel setter
- ② green light lamp
- ③ red light lamp(low battery indicator)
- ④ yellow light lamp(confirm key)
- ⑤ code put in or override code setter
- ⑥ power plug hole
- ⑦ signal plug hole
- ⑧ 10 digits keypad
- ⑨ knob

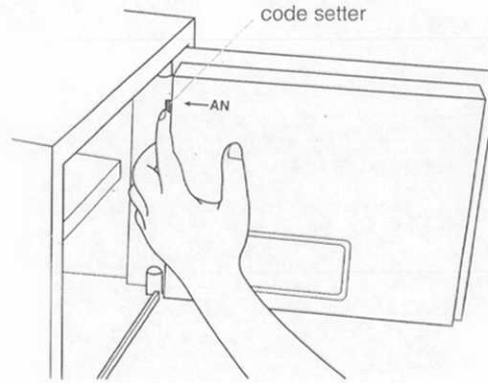

● Preparation:

1.Put one 9v battery cell into the "OVERRIDE KEY BOX" and draw out two rods,one being the power rod,the other the signal rod marked "EXT".

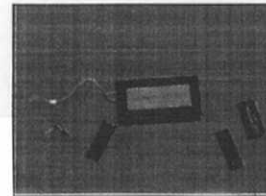

2.Insert the "POWER" plug into the plug hole marked "POWER" on the front of the safe and you will hear a "BEEP".Then press "0" and "ENTER" in succession.The green light will be on.Turn the knob and draw,and the door will be open.If the green light is on and the door is not open,turn the knob back(left) and turn it right again.The door will be open.

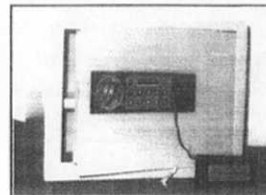
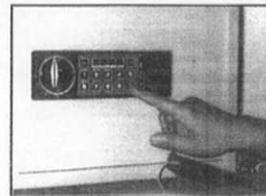
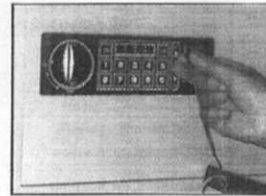

3.When two beeps are heard on pressing the "ENTER" key and the green Light is not on,insert the "EXT" plug into the plug hole marked "EXT". You will hear "BEEP" and see the green light on.Turn the knob and the door will be open.

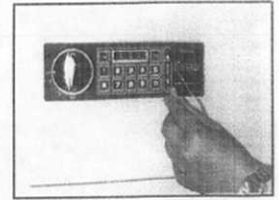

4.Install four 1.5V "AA" battery cells in the back of the safe door.Be sure the dircetion of the cells should be correct.

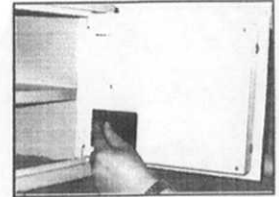

● Code-setting:

A.Override code setting

The safe comes preprogramed with an override code of "0".Please set your PIN with new code for safety.

1.Insert the "EXT"plug into the plug hole marked "EXT" on the front of the safe,you will hear a "BEEP".

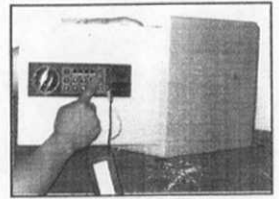

2.Input the new code as you like(max 12 digitals).Then keep the "AN" button pressed inside the safe and press "ENTER" key.You will hear a "BEEP".The new override code is set. For example:press "1 2 3 4 5 6" keys.Then keep the "AN" button pressed and press "ENTER" key.Now the new override code is set.

B.PIN setting

Input the PIN as you like(max 12 digitals) then keep the "AN" button pressed and press "PIN" key.You will hear a "BEEP",the new PIN is set. For example:press "6 5 4 3 2 1" keys.Then keep the "AN" button pressed and press "PIN" key.Now the new PIN is set.

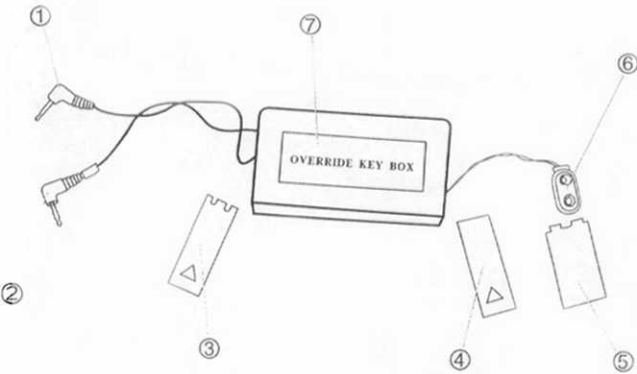

- ① power plug
- ② ext plug
- ③ cover 1
- ④ cover 2
- ⑤ 9v battery
- ⑥ battery connector
- ⑦ the override key box